

REVISIONS		
REV.	DESCRIPTION	DATE
NC	INITIAL RELEASE	4-5-95
A	REV PER ECN: 5844	

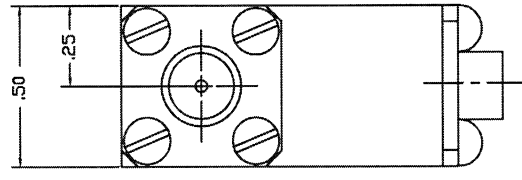
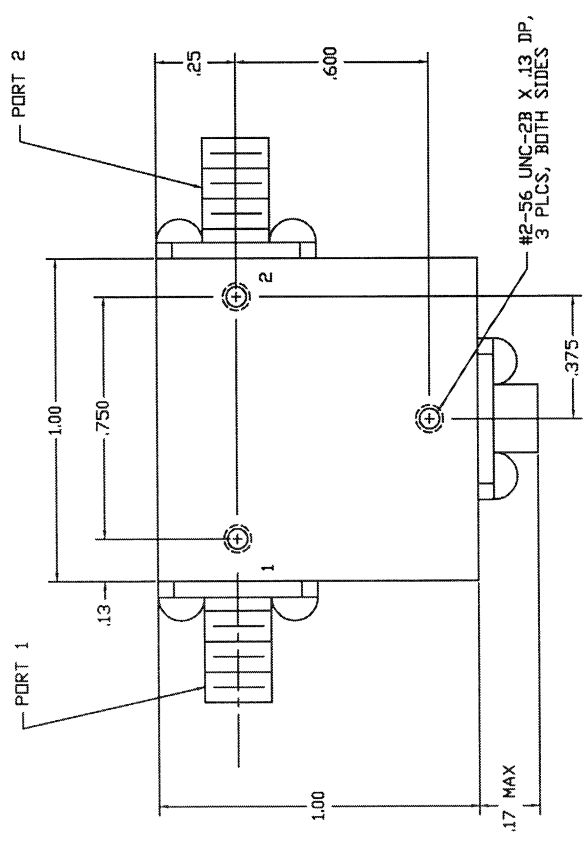

SPECIFICATIONS

1. FREQUENCY RANGE..... 2.0 TO 2.3 GHz
2. VSWR..... 1.25:1 MAX
3. ISOLATION..... 20 dB MIN
4. INSERTION LOSS..... 0.4 dB MIN
5. TEMPERATURE OPERATING..... -54° TO +85°C

CONNECTOR ORIENTATION			
DASH NO.	PORT 1	PORT 2	PORT 3
NONE	SMA FEMALE	SMA FEMALE	TERMINATED
-1	SMA MALE	SMA FEMALE	TERMINATED
-2	SMA FEMALE	SMA MALE	TERMINATED
-3	SMA MALE	SMA MALE	TERMINATED

NOTE: PART DRAWN IS SMI2023 WITH NO DASH NUMBER.

QTY	FSCN	RECD	NO.	PART OR IDENTIFYING NO.	NONCUMENTAL OR DESCRIPTION	MATERIAL SPECIFICATION
PARTS LIST						
FRACTIONS DECIMALS ANGLES ± 1/64 .XX ± .01 ± 1/2° .XXX ± .010		APPROVALS		DATE		
MATERIAL		DRAWN				
FINISH		CHECKED				
		ISSUED				
204-0265-001		SMI2023-X		USED ON		
NEXT ASSY		APPLICATION				
		SIERRA MICROWAVE TECHNOLOGY		OUTLINE FOR SMI2023-X		
		SIZE FSCN NO.		DWG. NO.		REV.
		B 1CY63		205-1923-001		
		SCALE		SHEET		