

REV.	DESCRIPTION	DATE	APPROVED
NC	INITIAL RELEASE		

SPECIFICATIONS

- FREQUENCY RANGE----- 2.3 TO 2.7 GHZ
- VSWR----- 1.25:1 MAX
- INSERTION LOSS----- 0.4 dB MAX
- TEMPERATURE
 OPERATING----- -54° TO +85° C
 STORAGE----- -54° TO +100° C

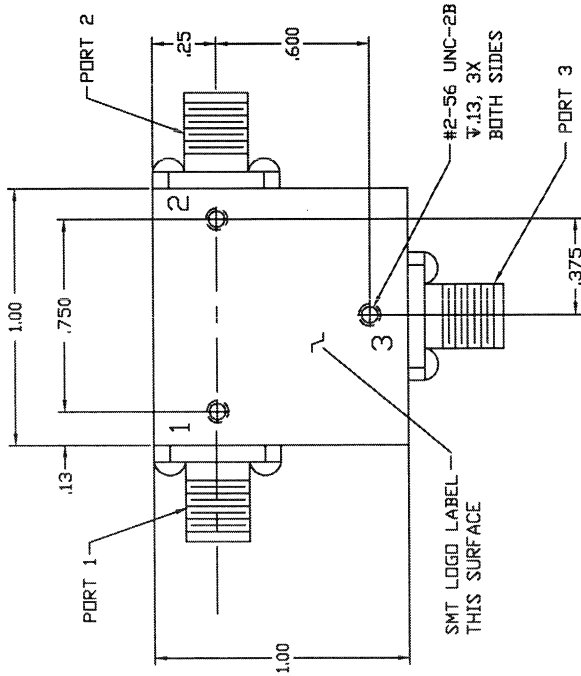
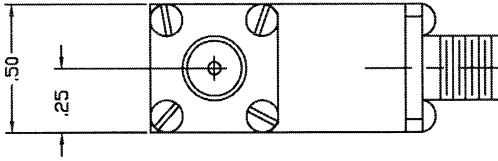

CONNECTOR ORIENTATION			
DASH NO.	PORT 1	PORT 2	PORT 3
NONE	SMA FEMALE	SMA FEMALE	SMA FEMALE
-1	SMA MALE	SMA FEMALE	SMA FEMALE
-2	SMA FEMALE	SMA MALE	SMA FEMALE
-3	SMA FEMALE	SMA FEMALE	SMA MALE
-4	SMA MALE	SMA MALE	SMA FEMALE
-5	SMA FEMALE	SMA MALE	SMA MALE
-6	SMA MALE	SMA MALE	SMA MALE
-7	SMA MALE	SMA FEMALE	SMA MALE

PART SHOWN IS SMC2327 - NO DASH NUMBER

204-0344-001		SMC2327-6	
204-0343-001	SMC2327-4, -5, -7	FRACTIONS DECIMALS ANGLES XXX .02 ± XXX .010 ±	
204-0342-001	SMC2327-1, -2, -3	MATERIAL	
204-0341-001	SMC2327	FINISH	
NEXT ASSY	USED ON	APPROVALS	
APPLICATION		DATE	
		DRAWN	
		CHECKED	
		ISSUED	
		SIZE	REV.
		B	
		FSCM NO.	DWG. NO.
		1CY63	205-2908-001
		SCALE	
		SIERRA MICROWAVE TECHNOLOGY	
		OUTLINE FOR SMC2327-X	